

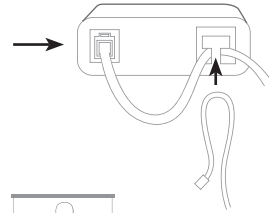

**Step 1**

**PLUG IN PAD**

- Plug the pad into the bottom of operational monitor.
- Be sure to lace the cord through the strain relief by gently pinching the cable into a loop and lacing it over the “T-shaped” strain relief.



**Step 2**

**BED PLACEMENT**

- Place pad under the sheet or under the mattress. The pad should be located under the shoulders to be alerted when resident sits up in bed.
- Place pad under lower back/buttocks to be alerted when the resident vacates the bed.

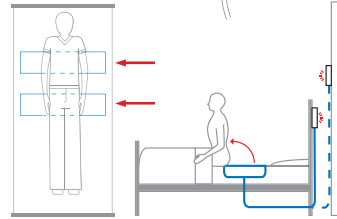

**WHEELCHAIR/CHAIR PLACEMENT**

- Center pad under buttocks.
- Place monitor out of reach of the resident. Suitable mounting locations include: back of headboard, back of wheelchair, wall or under the bed. Make sure that the resident cannot tamper with monitor or reach the “Reset” button. (It is the caregiver’s responsibility to route the cord under the sheet, so the resident cannot interfere with it).

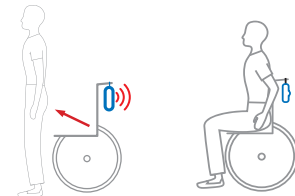

**Step 3**

**TEST SYSTEM**

- Test your system before every use.
- Apply pressure to the pad to trip the sensor device. The monitor will beep twice.
- The monitor is now active. Alarm will sound when pressure is released from the pad.
- See monitor instructions to silence an alarm.



**CARE & MAINTENANCE**

- When installing a new pad, write the date on pad in permanent marker. Change pad at the recommended time.
- When using a pressure pad in conjunction with foam or gel cushions, test system to make sure it will still work properly.
- Double-sided tape can be used to prevent the pad from slipping.
- A “chirping” monitor indicates your battery needs replacing.
- To minimize spreading infection, single patient use is recommended.
- To clean pads use disinfectant wipes or anti-bacterial cleaners. Do not fold or immerse pad in any solution.



**Bed & Chair Pressure Pads**

**Warning:** Failure to comply with warning may result in injury or death. This device is not suitable for all individuals. Other devices may be required. This device is not a substitute for visual monitoring by caregiver. The manufacturer does not claim that this device will stop elopement and or stop falls. This device is to help augment caregivers comprehensive resident mobility management program. Test this device before each use. Read the instructions and Legal Disclaimer.

Seller warrants that the goods sold will be free from defects of workmanship and manufacturing, for a period of one year from the date of sale. Other than this limited warranty, seller makes no express or implied warranties. Except for this limited warranty, NO EXPRESS OR IMPLIED WARRANTIES ARE GIVEN AND NO AFFIRMATION OF SELLER, BY WORDS OR ACTION, WILL CONSTITUTE A WARRANTY. THE GOODS BEING PURCHASED ARE BEING SOLD ON A “WITH ALL FAULTS” BASIS. THE ENTIRE RISK AS TO THE QUALITY AND PERFORMANCE OF THE GOODS IS WITH THE BUYER. SHOULD THE GOODS PROVE DEFECTIVE FOLLOWING THEIR PURCHASE, THE BUYER, AND NOT THE MANUFACTURER, DISTRIBUTOR OR RETAILER, ASSUMES THE ENTIRE COST OF ALL NECESSARY INSTALLATION, SERVICING OR REPAIRS.

The Smart Caregiver Corporation PPB Bed Pad & PPC Chair Pad Series are designed to be installed by the end-user. As such, it is the entire responsibility of the buyer to insure that the system is properly installed and tested. Further, the system is not designed to replace good care giving practices including, but not limited to:

- a.) Direct patient supervision
- b.) Adequate training for staff personnel for elopement
- c.) Testing of the system before each use.

WHERE PERMISSIBLE, IT IS THE SELLER'S INTENT TO LIMIT ANY LIABILITY FOR SPECIAL, CONSEQUENTIAL OR INCIDENTAL ECONOMIC DAMAGES TO REFUND OF THE PURCHASE PRICE OR REPLACEMENT OF THE GOODS. SELLER DISCLAIMS ANY LIABILITY FOR COMPENSATORY OR OTHER DAMAGES ARISING OUT OF THE USE OF THE GOODS.

**WARNING: The manufacturer does not claim that this device will stop elopement and or stop falls. This device is to help augment caregivers comprehensive resident mobility management program. This product is to be used by a licensed caregiver only.**

**Need Set-up Help?**

**Call Our Friendly Customer Service Reps at (800) 650-3637**



1229 N. McDowell Blvd, Petaluma, CA. 94954  
 sales@smartcaregivercorp.com  
 www.smartcaregivercorp.com  
 Toll Free: (800) 650-3637



- TL-2100E FallGuard Economy Monitor
- TL-2100CP FallGuard Change Pad Indicator™
- TL-2100V FallGuard Safety Auto-Reset Monitor w/Voice
- TL-2100S Safety Auto-Reset™ Fall Alarm
- Caregiver Key

**Optional Accessories:**

- PPC-W Chair Pressure Pad 6-Month Warranty (10"x15")
- PPC-90 Chair Pressure Pad 90-Day Warranty (7"x15")
- PPC-60 Chair Pressure Pad 60-Day Warranty (7"x14")

**Chair Pressure Pads:**

- PPB-90 Bed Pressure Pad 90-Day Warranty (5"x30")
- PPB-60 Bed Pressure Pad 60-Day Warranty (10"x30")
- PPB-W Bed Pressure Pad 6-Month Warranty (15"x30")

**Bed Pressure Pads:**

**Bed & Chair Pressure Pads:** Bed and Chair pressure pads function with the Smart 2100 Fall alarm series (listed below) with both an audible and visual alert. Both the Bed and chair pressure pads have specific Warranties. Change Pads at the recommended time.



1229 N. McDowell Blvd, Petaluma, CA. 94954  
sales@smartcaregivercorp.com  
www.smartcaregivercorp.com  
Toll Free: (800) 650-3637



# Installation Instructions

## Bed & Chair Pressure Pads

### Bed & Chair Pressure Pads

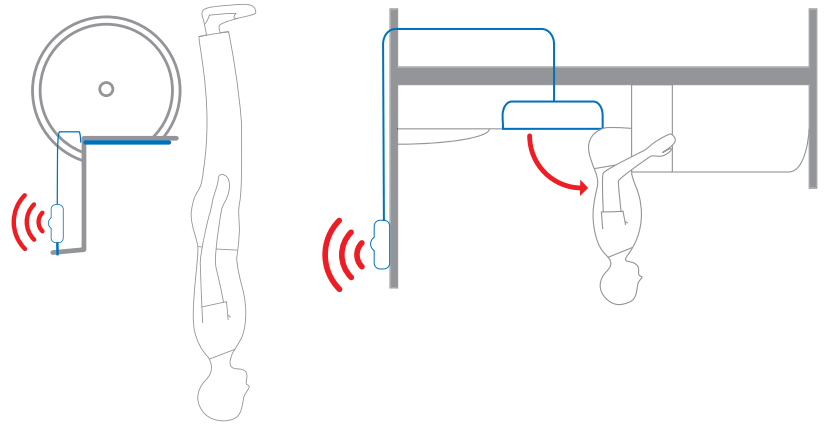

# Installation Instructions